

Setting Up the Roku

1. Plug the Roku Streaming Stick into an HDMI port on your TV. Connect the micro-USB cable (included) between the Stick and the included power adapter. Plug the power adapter into an A/C power outlet for instant-on connectivity.
2. Now turn on the TV. Look for a Roku logo to fill the screen. You may have to press the Input (or Source) button on your TV or TV remote to cycle through the various video inputs available until you see a Roku screen.
3. Connect to a wireless network. The Roku Streaming Stick should automatically detect wireless networks in your area. Using the Roku remote, select your home wireless network from the list of available networks. Enter your password, if applicable.

If the Roku does not automatically detect wireless networks:

1. Press the "Home" button on the Roku remote to get to the Home screen.
2. Use the arrows on the remote to navigate to "Settings", and then to "Network"
3. Select "Set up a new connection" or "Set up connection"
4. The Roku will search for networks in your area. Follow the directions in Step 3 above.
4. Press the "Home" button to return to the Home screen. Use the arrow buttons and OK button to select a channel. CADL Rokus have following channels: Roku Channel, Vudu, and Hoopla.

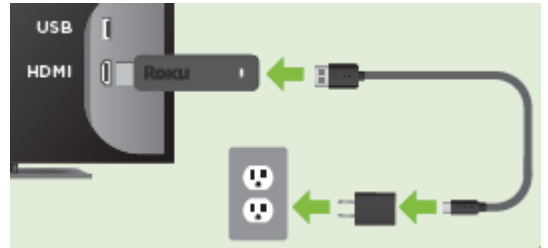
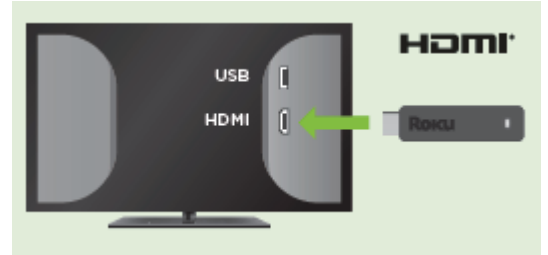

Roku Tips and Additional Information

- Additional channels may not be added to the Roku. Please refrain from changing any settings on the Roku, other than the Wireless Network connection.
- If the Roku will not fit into your HDMI port, you may need an HDMI extender cable. The library does not supply this cable.
- Don't have a home wireless network? CADL also circulates Rokus with hotspots. Check www.cadl.org/rokuhs for more information.
- If the Roku remote is not working, you may need to try pairing the remote again:
 - Open the battery compartment and remove the batteries from the remote.
 - Remove the power cable from the Roku device, wait 5 seconds and then re-connect the power cable.
 - When the Roku device displays the home screen, reinsert the batteries in the remote.
 - Press and hold the pairing button inside the battery compartment of the remote for 3 seconds or until you see the pairing light on the remote begin to flash. If the light does not flash, try again. If the light still does not flash, then the batteries.
 - Wait for 30 seconds while the remote establishes a connection with the Roku device.
 - The remote pairing dialog should appear on your TV screen.

Accessing Movies and TV Shows on the Vudu Channel

1. From the Roku home screen, select the Vudu channel.
2. Note the menu across the top of the screen. Use the arrows on the remote to navigate and select “My Vudu” from the menu along the top of the screen.
3. Press the down arrow once, then use the > arrow to highlight “Movies” or “TV Shows”.
4. Use the arrows to highlight your selection, press OK to select.
5. “Watch” should be highlighted. Press OK to select “Watch”.

Tips:

- You can press the * button on the Roku remote to turn on Closed captioning and access accessibility features.
- Movie too blurry or pausing? You may be able to switch to SD instead of HD. While viewing, press the Play/Pause button and use the arrow keys to navigate to HDX or HD. If SD is available, you can press the up arrow twice, then press OK to switch to SD.
- If your movie selection only shows “Resume”, instead of “Watch”, return to the menu on the top of the screen, and select “Watchlist” instead of “Movies” or “TV Shows”. Select the movie there and select “Start Over”.



Accessing Movies and TV Shows on Hoopla

**** Please note you need a phone, tablet device, or computer to link your Hoopla account to the Roku *****

1. Use the remote to select the Hoopla channel on the Roku home screen
2. Follow the onscreen directions to link your Hoopla account to the Roku
3. After you link your account, the screen should change to the Hoopla home screen

Use the Roku remote to navigate the Hoopla screen. You can borrow movies and tv shows directly from the Roku.

Please logout of your Hoopla account before returning the Roku to the Library. To logout:

1. In the Hoopla channel, use the Roku remote to navigate and select Settings in the left-hand menu.
2. Navigate to the Logout button and select it.

Your Hoopla account is no longer associated with the Roku.
(Library staff will ensure logout when the Roku is returned)

Tips:

- You can checkout a total of 12 items from hoopla a month.
- Items return automatically at the end of the checkout period.
- Find out more about Hoopla at : www.cadl.org/downloads