

Intuos

Intuos Pen & Touch

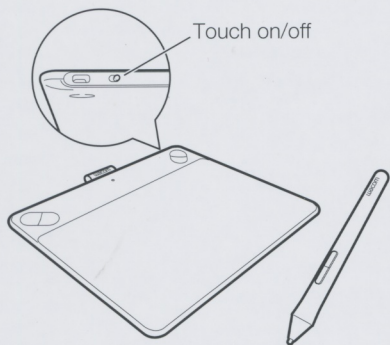

Intuos Pen

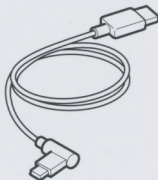
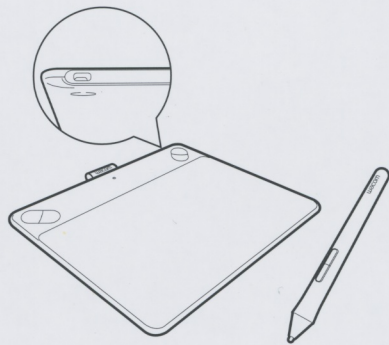

Setting up Intuos

1. Connect to the Internet.
2. Close all open applications.
3. Connect the USB cable.
 - When you connect the cable, your computer will install a device driver to support your tablet.

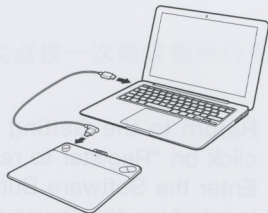

4. Install the Wacom driver to ensure full functionality of your Intuos.

- With an Internet connection (preferred method):
Go to the Getting Started page for Intuos (www.wacom.com/getting-started/intuos).
Click on "Download now."
- Follow the prompts to install the driver on your computer.

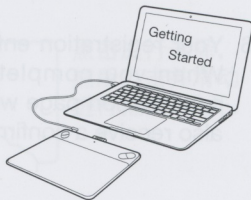

- Without an Internet connection: Run the installer from the Installation CD provided with your Intuos, and follow the prompts.
- When the driver installation is complete, your tablet is ready to use.

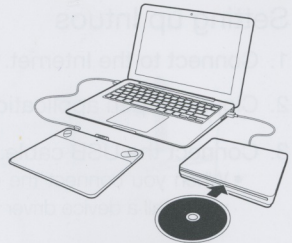

5. Return to the Getting Started page and click on “Register to redeem your offers.” Enter the Software Bundle Download key located on the lower right corner of the Intuos box, then fill in the form on your screen.

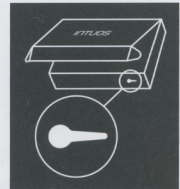

6. Your registration entitles you to free software to use with your Intuos. When you complete your registration, you will see a registration confirmation page with instructions for accessing the software. You will also receive a confirmation email.

Using the pen for navigation with Intuos

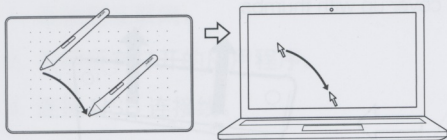

Move the pen slightly above the tablet, without touching the surface, to position the screen cursor.

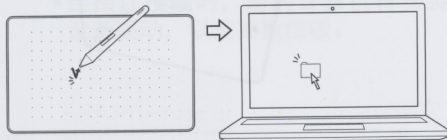

Tap the tablet once with the pen tip to select.

Using multi-touch with Intuos (Only for Intuos Pen & Touch)

Some gestures are unique to the Wacom tablet. See the Wacom gesture guide available on the “Getting Started” website to learn more (www.wacom.com/getting-started/intuos).

Tap to click

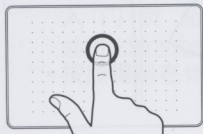

Using a single finger, tap to click. Tap twice to double-click.

Drag

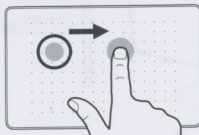

Tap to select, then tap and slide to drag. Lift to release.

Zoom

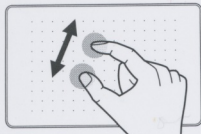

Zoom in by expanding your fingers away from one another. Zoom out by pinching your fingers together.

Rotate

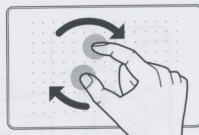

Move your fingers clockwise or counter-clockwise.

Open the cover

Push and slide cover up with thumbs

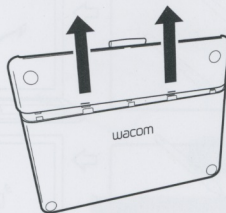
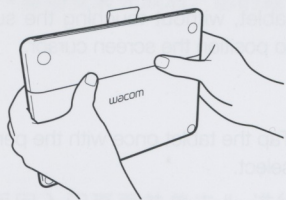

Close the cover

Slide down.

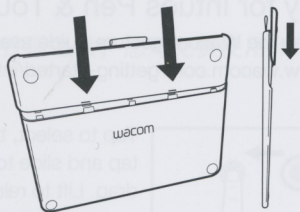

CAUTION

DO NOT PUSH SHUT

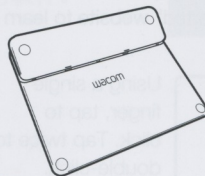

Replacing the nib

Insert, tilt and pull to remove.



Wireless accessory kit

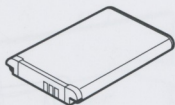

Wireless accessory kit: Enjoy the freedom and convenience of working wirelessly. Other accessories include pens and nibs designed to enhance your creativity.

To view or purchase the wireless kit and other accessories, visit the Wacom Store at www.wacom.com.

Important information

- Compatibility: Microsoft Windows® 10, Windows® 7 and Windows® 8, and Mac OS® X v10.8 or later.
- For support and to register your product, go to wacom.com and click on Support
- Information on using and customizing your Intuos, changing pen nibs, troubleshooting and more is available in the product Help. To view the Help, click on the ? icon in the Wacom Desktop Center or Wacom Tablet Properties.
- Information on tablet safety, care of your tablet, specifications, warranties and licensing is in the Important Product Information document, which is available from the Wacom Desktop Center.
- Check Wacom Support for updates to the Intuos driver. Go to wacom.com and click on Support.

© 2015 Wacom Co., Ltd. All rights reserved. Wacom, the logo and Intuos are trademarks and/or registered trademarks of Wacom Co., Ltd. All other company or product names are trademarks and/or registered trademarks of the respective company. Modifications and errors excepted.